

PART NO.	QTY	ITEM	DESCRIPTION
EAST0022	5	1	PILLOW BLOCK 1"
EAST0176	1	2	REAR SHAFT 100"
EAST0177	1	3	HANDLE FOR SEALER 100"
EAST0338	3	4	MAGNET HOLDER UPPER CENTER
EAST0456	4	5	W/F-HEAD RETURN ARM 6"
EAST0511	5	6	MACH-HOT KNIFE SADDLE
EAST0511E	3	7	MACH-HOT KNIFE SADDLE
EAST0514	3	8	MACH-HOT KNIFE SPACER BLK
EAST0514E	1	9	MACH-HOT KNIFE SPACER BLK EXTENDED
EAST0515	1	10	MACH-HOT KNIFE CORNER SPACER
EAST0559	2	11	H.K. ARM CASTING CENTER 40"
EAST0560	9	12	MACH-HOT KNIFE THRD RD 5/16" X 6"
EAST0629	1	13	FIREROD CART 220V 40" LONG
EAST0656	1	14	MACH-HOT KNIFE SEAL BAR UPPER FRONT 100"
EAST0657	1	15	H.K. SAFETY SHIELD FRONT OUTER 100"
EAST0658	1	16	H.K. SAFETY SHIELD FRONT INNER 100"
EAST0659	1	17	MACH-CROSS OVER BAR 100"
EAST0678	2	18	FIREROD CART 220V 50" LONG
EAST0775	1	19	HOT KNIFE SEAL BAR UPPER SIDE 40"
EAST0776	1	20	HOT KNIFE MUSHROOM INSERT SIDE 40"
EAST0778	1	21	H.K. SAFETY SHIELD SIDE INNER 40"
EAST0779	1	22	H.K. SAFETY SHIELD SIDE OUTER 40"
EAST0781	1	23	H.K. ARM CASTING 40" EXIT
EAST0782	1	24	H.K. ARM CASTING 40" INFEED
EAST0786	1	25	HOT KNIFE MUSHROOM INSERT FRONT 50"
EAST0786 IN	1	26	HOT KNIFE MUSHROOM INSERT FRONT-IN 50"
EAST0810	3	27	HOT KNIFE MAGNET HOLDER CENTER
EAST0839	1	28	HOT KNIFE CUTTING RULE FRONT 100"
EAST0867	1	29	HOT KNIFE CUTTING RULE SIDE 40"
EAST0900	3	30	MACH-MAGNET HOLDER UPPER CTR BLK
EAST0901	3	31	MACH-MAGNET HOLD UP PAD BLK
EAST1007	5	32	SAFETY SHIELD SPRING
EAST1018	2	33	COLLAR 1"
EP000095	6	34	MACH-HOT KNIFE SPACER BLACK W/HOLE
EP000535	3	35	THERMOCOUPLE HOT KNIFE
ESC00037	1	36	MACH-HOT KNIFE SADDLE CENTER
SUBA0065	2	37	ASSY-MAGNET UPPER
WH209	3	38	SPLIT TENSION PIN 3/16 x 1 1/4
XH348	9	39	SPLIT PIN 3/16
XH360	5	40	BOLT SHOULDER 1/4 x 1 1/4

REVISIONS						
REV	ECO #	DESCRIPTION	DRAFT	CHKR	APPR	DATE
1	-/-	INITIAL RELEASE	TMS	TMS	TMS	8-28-14

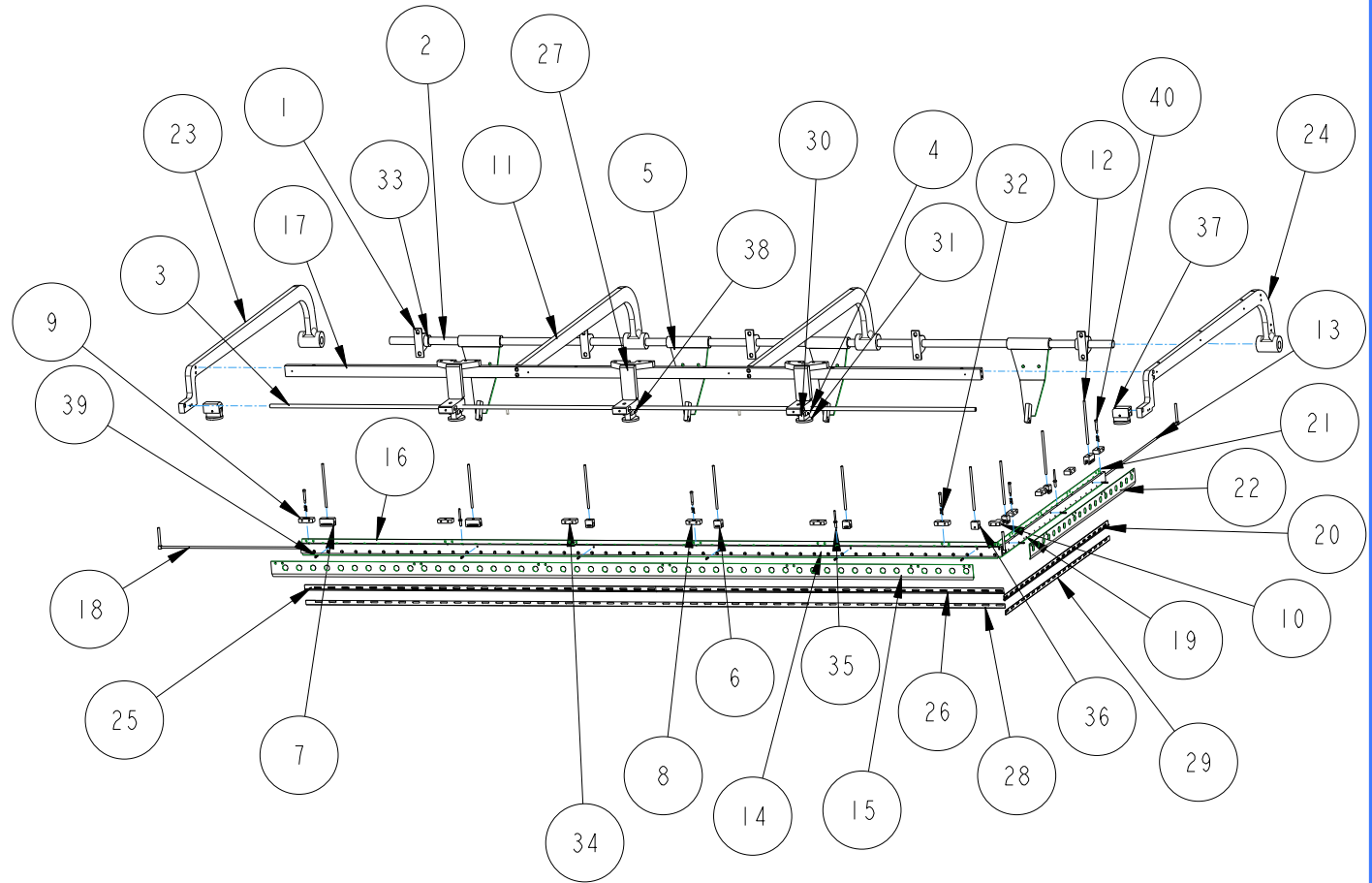

UNLESS OTHERWISE SPECIFIED .XX = ± 0.01 .XXX = ± 0.001 ANGLE = ± 0.5 INTERPRET DIM AND TOL PER ASME Y14.5M-1994	MATERIAL SEE BOM	<b>ENGAGE</b> <i>technologies corporation</i> Squid Ink Cogent Technologies Hestey Enterprises Ez-Tek Industries 7041 Boone Ave. N. Brooklyn Park, Mn 55428 1-800-871-2628		
	FINISH N/A			
THIRD ANGLE PROJECTION	DRAWN BY TMS   8-28-14 MODELED BY TMS   8-28-14	TITLE HOT KNIFE KIT 40X100 MUSHROOM INSERT SILVERSTONE		
THIS DOCUMENT AND THE DATA DISCLOSED HEREIN OR HEREWITH IS NOT TO BE REPRODUCED, USED OR OTHERWISE DISCLOSED IN WHOLE OR IN PART TO ANYONE WITHOUT THE WRITTEN CONSENT OF ENGAGE TECHNOLOGIES.	SIZE	MODEL NUMBER	DRAWING NUMBER	REV
	SCALE	ASUBA0211-40100	UBA0211-40100	1